

# Bishop Road

## BISHOPSTON

APPROXIMATE FLOOR AREA  
111.5 SQM / 1200 SQFT



GROUND FLOOR  
648 sq.ft. (60.2 sq.m.) approx.

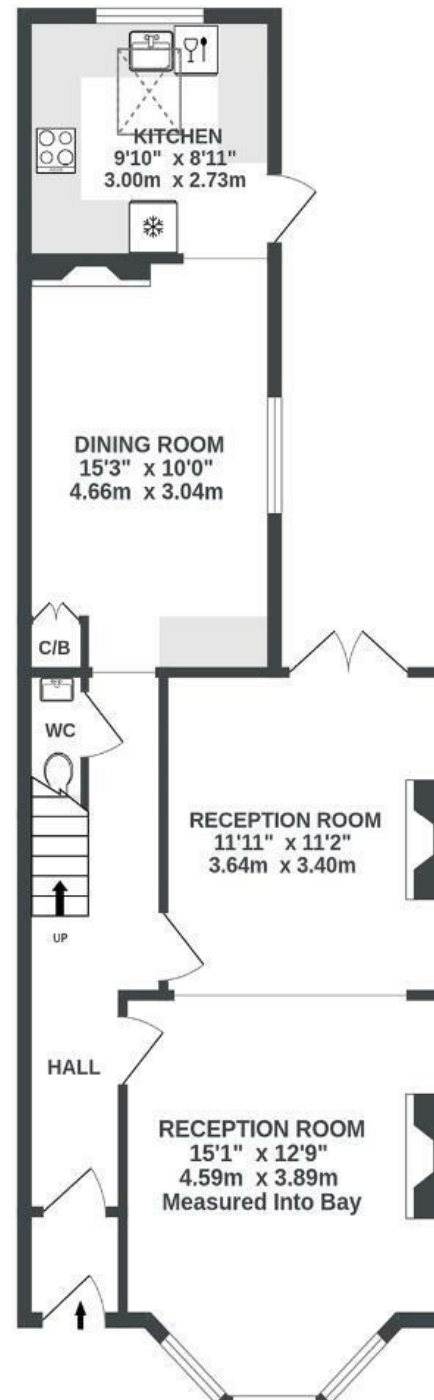

1ST FLOOR  
552 sq.ft. (51.3 sq.m.) approx.



Illustrations are for reference purposes only, measurements are approximate, not to scale.

Boardwalk

# Bishop Road

## BISHOPSTON, BRISTOL



£650,000



3 Bedrooms



BS7 8LZ



2 Bathrooms

*"We love having the dining area just off the kitchen because we can easily cook and serve while also keeping the dirty dishes out of sight while we eat! The living room has been a great space to watch our babies learn to crawl and then walk. Having the French doors open onto the patio in the summer meant they could flow in and out of the garden to play. The garden is lovely in the summer with a paddling pool and a BBQ. It's been a wonderful family home for us and our three kids."*

